

Application

Stamping press tonnage monitoring.

Industry

- Machine Tool Industry
- Stamping Industry

Application Overview

In stamping press applications, tonnage monitoring provides critical information to machine operators, to help protect presses and dies from excessive force, premature wear, or costly damage. Faster setup times are possible, as operators adjust to known settings rather than estimates.

Application Challenges

- Extremely high stresses are placed on stamping presses, so any sensor must resist these forces.
- Available space is limited, so a small package size is required.

Solution(s)

- Indirect force measure via Baumer strain link sensors provides accurate tonnage information in a small package size.

Examples include the following:

- DSRT 22DD Series
- DSRT 22DB Series
- DSRT 22DJ Series
- DSRT 1000 Series
- DSRT 1300 Series
- DSRT 1400 Series

Supporting Documentation

- Baumer Force and Strain Catalog, pages 5.4 through 5.14.
- Baumer Website:
 - [DSRT 22DD Series](#)
 - [DSRT 22DB Series](#)
 - [DSRT 22DJ Series](#)
 - [DSRT 1000 Series](#)
 - [DSRT 1300 Series](#)
 - [DSRT 1400 Series](#)

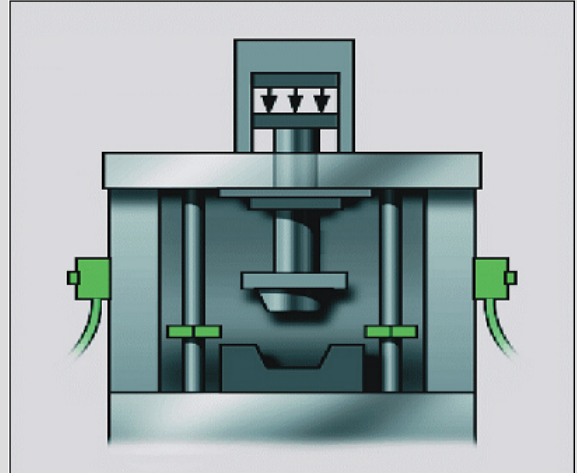

Baumer strain link sensor monitors and reports tonnage at various points on a stamping press.

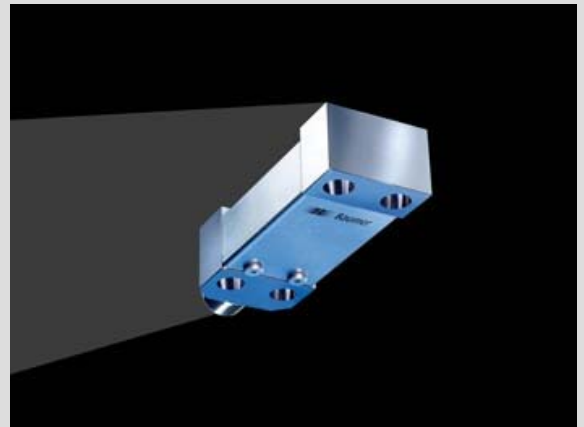

For application information, contact:

Baumer Ltd.
122 Spring Street, Unit C-6
Southington, CT 06489

Phone: (860) 621-2121

Fax: (860) 628-6280

E-mail: sales.us@baumergroup.com

www.baumergroup.com

Customer Service/Technical Support: (800) 937-9336